

Connections

For the member-owners of Federated Rural Electric



Volume 25, Issue 2

Play our missing members capital credits game! Pass 'Go' to be paid



Play our missing members board game. Head to "Go call the co-op" to help them collect money! Their money in "Community Chest" awaits!

These former co-operative members moved and we no longer have their current address. Yet, they are still owed capital credits or their share of a profitable year.

Go to Pages 1-3

and 6. Help Federated Rural Electric and Brown County REA (BCREA) locate these missing members and provide us new addresses. Their capital credits check was returned last year — address unknown. If you know the current location for any of these members, please have them call or e-mail the appropriate cooperative with their new address and/or phone number. We'll then mail their capital credits check. In addition, BCREA's list also includes older, uncashed accounts payable checks. More names are listed this year as two wholesale power suppliers retired capital credit checks. Great River Energy retired capital credits from 1980-86, plus Southern Minnesota Energy Cooperative retired funds from 2014-2017.

If we do not receive new addresses on these missing members, their unclaimed capital credits checks are donated to a tax-exempt organization. Brown County Rural Electrical Association and Federated Rural Electric donate unclaimed capital credits to their Operation Round Up program. Brown County REA's Round Up Trust donates to charitable organizations, individuals and families in crisis and scholarships in the co-op service area. Federated's Round Up Trust Board awards nine high school scholarships. 

Former Federated

members: Call Angie direct 507-849-7847 or 1-800-321-3520 (extension 2233) or e-mail ziemer@federatedrea.coop.

Cleo Viola Ahrens	Windom
Mrs. Douglas Ahrenstorff	Lakefield
Arthur Albrecht	Excelsior
Agnes Aldrich	Jackson
Esther Allen	Lakefield
Mary L. Allen	Heron Lake
Darrell Amundson	Ruthon
Chas C. Andersen	Stockholm, WI
Curtis Anderson	Ceylon
John O. Anderson	Burnsville
Arlen Arndt	Brewster
Janice Atz	Lakefield
Margaret Bauman	Lakefield
Norman & Sylvi Baddgor, c/o	Jim Carsten
	Bingham Lake
Eunice Bauman	Okabena
Brent Baumann	Wabasso
George Becker	Fairmont
Ralph Becker	Fairmont
Laurie Behrens	Windom
Harvey Beuthien	Lakefield
Vincent J. Bezdicek	Jackson
Fred Blom, Sr.	Estherville, IA
Vernon W. Boehne	Fairmont
Clyde V. Bong	Welcome
Mary Bowers	Fair Oaks Ranch, TX
Bettyann Bradley	Fairmont

— Continued on Page 2

At A Glance



The Operation Round Up applications due Feb. 12

Encourage local organizations to apply for the spring round of funding. Visit our website for the application: www.federatedrea.coop or call our office to request it. Funding is available for community service/public safety, education/youth, environmental, emergency-energy assistance and disaster relief. 

This publication focuses on cooperative savings, programs and events. As this is the official member publication, member's story ideas, letters-to-the-editor and comments are welcomed.

Andrea Christoffer, CCC, Editor
 "Owned by those it serves"

POSTMASTER: Send address changes to *Connections*, PO Box 69, Jackson MN 56143-0069.

Printed by Livewire Printing, Jackson, on recycled paper with soy ink.



Open capital credits community chest

— Continued on Page 2

Erwin Burmeister	Lakefield
Carl Bredberg	Bloomington
Colleen M. Bressler	Winnebago
Joel Bristow	Dundee
Leonora Butler	Winnebago
Richard L. Carlson	Canby
Carolyn Carman	Columbus, MT
Arlen Cegelske	Truman
John Chergosky, Jr.	Truman
Mary Ann Clarke	Sioux City, IA
Delmar Classon	Fairmont
Gloria Cook	Rochester
Acres Countryside	Lakefield
Harold Conlin	Chancellor, SD
Alfred Coyer	Perham
Richard Danielson	Fairmont
Clarence Darnell	Fairmont
Robert Dauffenback	Lakefield
Dick Detert	Viroqua, WI
Ruth Devine	Byron, MI
Marvin Dewall	Beulah, WY
Kolton D. Dilly	Truman
Arlene Driehorst	Welcome
James Dunlap	Hartford, SD
Jake Dkykstra	Jackson
Daniel Egertson	Thornton, IA
Raymond Eggimann	Waseca
William Eickhoff	New York Mills
Eileen Eike	Pocahontas, IA
Elaine Elston	Cottonwood
Roger Erickson	Welcome
Reid Erpestad	Windom
Fairmont Equip Co Inc	Fairmont
John Ferguson	Spirit Lake, IA
Robert Carl Fliflet	Bird Island
Keith Foster	Winnebago
Milton Fricke	Lakefield
John Garber	Jackson
Mary Gellert	Fairmont
Paul Gerhardt	Fairmont
Jerry Gettler	Mesa, AZ
Gary Gilreath	Winnebago
Kevin Grant	Winnebago
Carol Groene	Worthington
Peter Gronewold	Luverne



Lloyd Groshens	Jackson
Warren C. Groshens	Minnetonka
Kathryn W. Guerdet	Truman
Herbert Guritz	Fairmont
Roger Guritz, c/o Herbert Guritz	Fairmont
Clara E. Hall	Fairmont
Randy Hammer	Waconia
Wayne E. Hansen	Peterson, IA
Chester M. Hanson	Windom
Ronald Harder	Jackson
John Hardman	Wilson, WI
Mrs. Lillian Hartwig, c/o John Ringeisen	Sherburn
Donovan Hayostek, c/o Marvin Hayostek	Lake Park, IA
Arnold Hatch	Truman
Philip Heup	Fairmont
Russell Hill	St. Regis, MT
Hilltop Mennonite Church,	Johnstown, OH
Lois Hines	Truman
Peter Hinker	Roseville
Jamee L. Hinrichsen	Fairmont
Max Hoelscher	Windom
Terrance Hopp	Mankato
Donald Howard	Winnebago
Ronald Householder	Fairmont
Howard L. Humburg, c/o Humburg-Carter Farm	Welcome
Loel Hunt	Alpha
Clare Hybbert	Jackson

Donald D. Ihnen	Lake Park, IA
Maurice Ifff	Cloquet
Lowell Jaeger	Brainerd
Keith Jaspers	Rogersville, MO
Arlyn Jensen	Granada
Javier Jimenez	Heron Lake
E. Morris Johnson	Menahga
David Johnson	Barboursville, WV
Earl Johnson	Sherburn
James J. Johnson	Windom
Warren Johnson	Worthington
Leroy Jones	Trimont
Roger Jorgensen	Lebanon, MO
Harlen Julius	Arnolds Park, IA
Matthew Junker	Garretson, SD
Kenneth Kabage	Granada
George M. Kanuch	Jackson
E. A. Kautz, c/o Allen Kautz	Estherville, IA
Harold Kelly	Truman
Edward Kielty	Windom
Daniel Kleinbeck	Fort Collins, CO
Fred Wm. Knuth	Luverne
Roland Knudson	Lakefield
Bruce Knutson, c/o Kenneth Knutson	Lakefield
Knutson Family Trust, c/o Laurel Quiring	Windom
KOA Kampground, c/o Ken Helgeson	Jackson
Evelyn Kolander	Lakefield
Carol Kostecki	Berthoud, CO
Thomas Koster	Onalaska, WI
Emil Kruse	Fairmont
I&L Implement Inc, c/o Jay Franz,	Fairmont
State Bank Mountain Lake	Mountain Lake
Warren Landin, c/o Blain Landin	Granada
Donald Larsen	Fairmont
Werner Laue	Fairmont
Maynard Lemier	Fairmont
David Lenort	Fairmont
Ed Lloyd, Jr.	Harris, IA
Arthur Loeschon	Granada
Raymond Loeschon	Worthington
Richard Lorenz	New Richland
Ted Ludlow	Southampton, MA
Arlo L. Lueth	Fairmont

— Continued on Page 3

This 'chance' card pays out unclaimed co-op capital credits

— Continued from Page 2

Winnifred M. Luhmann Fairmont
 John Lundblad Northfield
 James Lusk Jackson
 Glenn A. McArthur Canby
 Darrell McCleary Largo, FL
 Kathryn McGinnis Andover
 Thomas Maday Fairmont
 Clarence J. Majerus New Ulm
 Kenneth Malo West Salem, WI
 Richard Malo Fairmont
 Jerry Mapson Granada
 Josephine Mapson Granada
 Randy Mapson Emily
 Mildred Markman Jackson
 Leslie Martin Sherburn
 James Mathiason Granada
 Sarah Mattes Ceylon
 MCI Telecomm Corp Chicago, IL
 Art Meyer Winnebago
 Lucille Meyer Alpha
 Benjamin D. Middagh Heron Lake
 Louis D. Mier Lakefield
 Carl Milow Sanibel, FL
 Mrs. Wm. Molkenthin, c/o Lorence Voehl
 Worthington
 Richard Monson Becker
 Joe Morris Jackson
 Helen Mosloski Fairmont
 Eldon Munsterman Granada
 Julie Myrdal, c/o Rocky Oak Windom
 Janet Myrvold Wilder
 Clark Nafziger Marshall
 Douglas Nawrocki Marshall
 T.C. Nawrocki Fairmont
 Walter Neitzel Jackson
 Joanne Nelson Ham Lake
 Randy Nelson Ham Lake
 Phyllis Neuenschwander Fairmont
 Glenn Niss Welcome
 Oscar Nohrenberg, c/o Kitty Nohrenberg
 Jackson
 Gertrude O'Connor Lakefield
 Larry J. Olsen Sherburn
 George O. Olson, c/o Maynard Olson
 Mountain Lake
 Carol Wells Olson Fairmont
 Kenneth J. Onken Minneapolis
 Gary Orloske Hill Top City, SD
 Gustave Orloske, c/o Albert Koep, Hill Top
 City, SD
 Lawrence F. Osborn Dickens, IA
 Peter Overaas Jackson
 Charles Paden Windom
 George J. Paulsen, c/o Norman Paulsen



Renee Pavelko Lakefield
 Donald Pawlitschek Heron Lake
 Clarence Peil Spirit Lake, IA
 Ardyce Pell Dolliver, IA
 Roger Pell Sun City, AZ
 Arvid E. Peterson, Jr. Zapata, TX
 Peterson Brothers Jackson
 Louis Petrowiak Fairmont
 Patricia A. Petrowiak Fairmont
 William Petrowiak Welcome
 Leon Pigman Lakefield
 Gail D. Pike Sherburn
 Curtis Pietz Worthington
 Leland Pohlman Lakefield
 Robert Pomerenko Mesa, AZ
 Larry Porter Mason City, IA
 Milton Prochaska Windom
 Jim Prochazka Jackson
 Gordon Prokes Lakeville
 C.H. Prull Fairmont
 Warren & Mike Prust Ceylon
 Alvin Purrington Windom
 Roman Pytleski Fairmont
 Richard Reese Spirit Lake, IA
 Sharon Reese Huntington Beach, CA
 Jerome D. Reinke Truman
 Dean Richard Fairmont
 Leland Ricard New Hope
 Ray Ricard Fairmont
 Hilda Rickert Chisago City
 Marvin Roenfeld Fairmont
 Lloyd Rients Worthington
 Leola Rogers, c/o Lorna Kruger Brewster
 Virginia Rohwer Lakefield
 John Romo Jackson
 Linda Roslansky Jackson
 Jim Rossow, c/o Harry R. Johnson Lakefield
 Virgil Rossow Lakefield
 Gerald Russenberger Trimont
 Jean Hample Sabatka Inver Grove Heights
 Lois Sackett Truman
 Paul Sandoz Fairmont
 Lynn Schmidt Crosslake
 Rod Schmidt Rapid City, SD
 Tony Schmidt Apple Valley

Warren Scheeberger Shakopee
 Elaine Schnieder Worthington
 John Schreiber Lakefield
 Gary Schuchard Pine Island
 Ruth Schueler Ceylon
 Everett Schulz Windom
 DuWaine Sell Windom
 Barry Sharp Fairmont
 (Moeller) Shimmin Fairmont
 Kent Stump Rapid City, SD
 Kelly Sloneker, c/o D. Broisma Blue Earth
 Lloyd E. Slykhuis Brewster
 David L. Smith Red Oak, IA
 Roger W. Smith Two Harbors
 Duane E. Sogge Saint Michael
 Linda Soucek, c/o Jody Rizzi Jackson
 Kenneth Sourbeck St. Peter
 J.B. Spencer Fairmont
 Grace Stinar Jackson
 Orville R. Strohmam Forest City, IA
 Alice Struss Granada
 Heinrich J. Stumpf Estherville, IA
 Dick Sunderman Westbrook
 Symens Brothers Heron Lake
 T. Temple Brulingame Mankato
 Mark Teaser Truman
 Steven Teaser Minneapolis
 Randee Thate Fairmont
 Allen Thompson Ames, IA
 Marvin Thompson Jackson
 Merval Thompson Windom
 Russell Thompson Fairmont
 Janice Tietje Fairmont
 Terry Timko Brush, CO
 John Van Dam Okabena
 Joe Vancura, c/o Rosella Vancura Lakefield
 Christopher J. Vasvick, Amy J. Vasvick
 Fairmont
 Art Veenker Bingham Lake
 Carmen Voehl Lakefield
 Kenneth R. Voigt New Ulm
 Betty Voss Spirit Lake, IA
 James Wagner, c/o John Wagner Elmore
 John Wagner Blue Earth
 Margaret Walker Worthington
 Edward Watje New Brighton
 Lyle Weber Emily
 Ronald Weber Granada
 Wilbur M. Weber Fairfield, CA
 Welcome Hardware Welcome
 Our Own Hardware Welcome
 Maynard Wendlandt Prescott Valley, AZ
 Mildred Werling, c/o Guardian Services
 Truman

— Continued on Page 6

Federated Focus

Your contact info correct?



Look at your electric bill. Do we still have you

listed with a landline phone number that was dropped? If you cut the cord with your landline, tell us your new cell phone number(s). We can list up to three phone numbers on your account. Plus, tell us your e-mail address. Then we can communicate with you for planned outages. E-mail us (billing@federatedrea.coop) or call us during business hours. This helps us serve you better.

Residential rebates available



Federated's residential rebates are the same as last year. Visit our website www.federatedrea.coop

for the rebate form; otherwise, call the office or send an e-mail to info@federatedrea.coop to request it.

- \$50 Energy Star refrigerator with proof of recycling the old one.
- \$50 Energy Star freezer with proof of recycling the old one.
- \$25 for an Energy Star dehumidifier.
- \$25 for a smart Wi-Fi thermostat.
- \$300 for ductless air source heat pump.
- \$350/ton for ground source heat pump.
- \$1,000 for air source heat pump SEER 14-15.
- \$1,500 for air source heat pump SEER 17 or higher.

Watch for details next month on the new electric vehicle charger rebate that will be coming. (6)

High school seniors: watch for \$700 Operation Round Up scholarship form in February bills

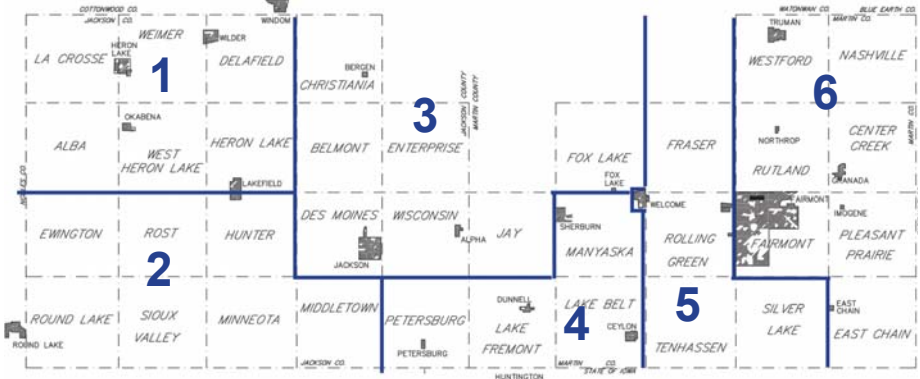

The map shows the districts where the six scholarships will be awarded, plus three more chances to win under District At-Large.



High school seniors: the Operation Round Up Scholarship application is now available. The application came with the February electric bill. Otherwise, find the application on Federated's website (www.federatedrea.coop), call or e-mail info@federatedrea.coop. Otherwise, stop by your school counselor's office for it. The student

must be the son or daughter of a current Federated member.

Federated's Trust Board approved awarding one \$700 scholarship for each of the six Federated districts and then three more from the remaining applications combined for additional chances to win one (a total of nine scholarships). The applications are due back at Federated's office by April 1, 2021. All nine recipients will be notified by May 1 with their photos published in the June *Connections* newsletter.

Students will receive the scholarship check after completion of the first semester of higher education with a 2.0 GPA or higher and submit proof of registration for the next semester. The scholarship check will be jointly issued to the school and student. (6)

Federated Rural Electric Bill Payment Options

AUTO PAY



REA DROP BOX & WELCOME STATE BANK

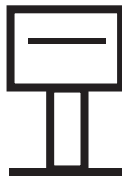

FEDERATED APP



CALL US



ONLINE PAY



MAIL



Go to our website for details or call us for more info!

Co-op's 2021 work plan invests \$1.7 million in substation work & upgrades

This year Federated will invest \$1.7 million mainly in substation improvements. Check out this map outlining the locations of the work.

1 Replace the Sherburn substation that came from Alliant during the customer acquisition in 2015. It is the only substation at a voltage of 2,400. Federated will build a new substation at 7,200 volts. This way when an outage occurs, Federated would be able to backfeed or reroute power from nearby Federated substations so the outage is shorter. This entails new land, foundation, fencing, transformers and other equipment. The majority of the transformers and other equipment that's not 15 kilovolts (kv) will need to be changed out throughout the town as well. New three-phase lines, called tie lines, will also be built to connect it to other Federated power lines and substations. The existing substation will then be removed and the site restored. Nearly half of the budget goes to this major project.

2 Three-phase line from the Truman substation will be rebuilt four miles east from County Road 39 along 160th Street. This line will be rebuilt as T-2 conductor, which is line that has a slight twist and resists ice buildup.

3 The following substations are slated for Substation Control and Data Acquisition (SCADA) equipment: Truman, Miloma, Wisconsin and West Lakefield. SCADA is a monitoring and alarm system in the substation. It helps identify and solves a problem before it becomes an outage and helps Federated to troubleshoot outages more quickly.

4 The Truman and West Lakefield substations will also have the old hydraulic oil circuit reclosers (OCRs) replaced with electronic reclosers. OCRs are working when you see the lights blink three times before an outage. The OCRs are trying to see if the tree branch or critter is no longer in contact with the line. It automatically

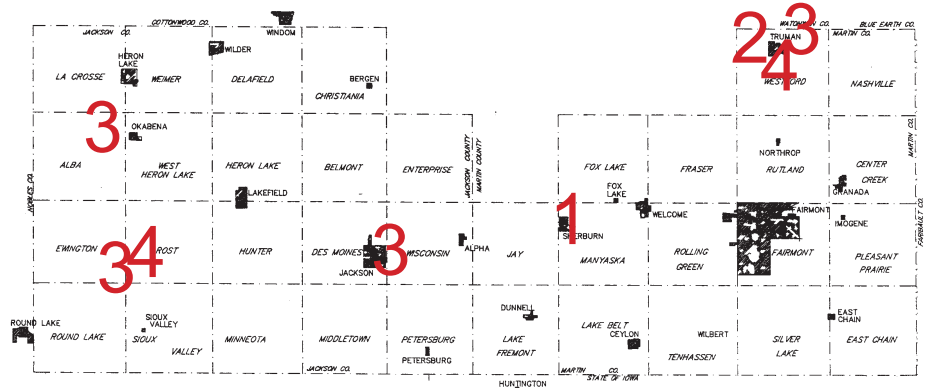

The numbers indicate the work that will be done in this area under the 2021 construction work plan to provide reliable electricity to members.



Federated's largest project over the next two years will involve building a new substation in Sherburn. The existing one from the Alliant acquisition cannot be backfed with the co-op's other substations due to the different voltage. A new substation will provide better reliability and more space for line trucks to maneuver.

tries three times before staying off until a lineman comes to inspect and make repairs.

Electronic reclosers require less scheduled maintenance. Previously, every three years the hydraulic ones must be taken out of service (removed from the line by linemen) and replaced with a freshly maintained OCR. Then the OCR had to be tested, the oil changed and replaced any parts that are worn or broken. The only maintenance required on electronic reclosers is to replace a battery every 10 years, which can be done with the

recloser still in service. Plus, many of Federated's hydraulic reclosers are 70-years old or more and need to be replaced. The electronic reclosers operate faster on a fault and coordinate with each other better keeping the outage to as small of a section as possible. This is the fourth year of installing these electronic reclosers, which will be done at all substations by 2024.

5 Finally, approximately 15 miles of old conductor will be replaced with new lines. (C)

Co-op 'utility' pays back capital credits

— Continued from Page 3

Orrie Werner Jackson
 Delmar Whitacker, c/o Marvel Whitaker Fairmont
 Helen Whitehead Fairmont
 John Wiggins Clinton, IA
 Robert Willink Silver City, NM
 Tom Winter Sioux Center, IA
 Delbert Wittrock Lake Park, IA
 Chester Wohlers Jackson
 Beverly A. Worshek Fairmont
 Donald G. Worthley Spencer, IA
 Gary Wright Fairmont
 Margie I. Yarns Fargo, ND
 Yellow Freight Systems Lakefield
 John Zellar Solway
 Susan Zielske Fairmont
 Dennis Ziemann Fairmont
 Marvin Zishka Lakefield

Former Brown County members: Call 794-3331 or 1-800-658-2368. Otherwise, e-mail bcrea@bcrea.coop.

Akin, Chad R. Frankfort, SD
 Anderson, Brian New Ulm
 Anderson, Jennifer New Ulm
 Bastian, Dino J. New Ulm
 Bauer, Lois Darwin
 Bergstron, Meghann T. Comfrey
 Bouton, Leah Kronenwetter, WI
 Braam, Jerry L. Fairfax
 Buegler, Dennis L. New Ulm
 Bunce, Shanna M. Eugene, OR
 Cano, Juan R. Crystal City, TX
 Cimino, James & Rose Cohasset
 Cochran, Lloyd C. Deforest, WI
 Cruz, Ruben Laredo, TX
 Delite Outdoor Inc. St. Paul
 Dietz, Jake New Ulm
 Dittbenner, Armin Sleepy Eye
 Elbert, Jesse Eagle Bend
 Ellanson, Bernice New Ulm
 Fehlman, Roman New Ulm
 Frederick, Thomas Mankato
 Frederickson, Carole & Vernell St. James
 Frederickson, Vernell St. James
 Gleisner, Richard E. New Ulm
 Goblirsch, Maxine New Ulm

Gonzales, Jesus
 Grathwohl, Lonnie
 Graves, Richard
 Greibel, Joseph E.
 Guggisberg, Kenneth A.
 Hacker, Marvin E.
 Hall, Joshua
 Hanson, Jerome A.
 Harmening, Roman Est.
 Harris, Douglas B.
 Hazelton, Robert
 Helget, Richard E.
 Helget, Victor
 Holm, Robert B.
 Hovland, Marilyn
 Hunstad, Jonathan
 Irlbeck, Daniel C.
 Jensen, Steven
 Johnson, Amy
 Jones, David Grant
 Kathman, Taylor A.
 Kizer Sr., Mrs. Robert L.
 Klossner, Loretta
 Knoll, Leroy A.
 Kruse, Wayne W.
 Kuehl, Daniel J.
 Kuester, Raymond
 Lade, Terance
 Landkammer, Wilfred
 Larson, Kurt C.
 Lebens, Christine
 Lee, Martin & Candace
 Lenzen, Dennis J.
 Lothert, Dale E.
 Mcguire, Duane
 Means, Daniel
 Melzer, Elsworth
 Meyer, Karyl
 Miller, Dean
 Miller, Leland L.
 Moldaschel, Jane
 Montaivo, Francisco
 Montanye, Harry R.
 Morales, Joseph
 Nehring, Brian D.
 Neid, Lynn
 Nelson, Gertie A.
 Nelson, Robert P.
 Norby, Judy K.
 Novak, Marilyn
 Olson, Allen E.
 Olson, Diane M.
 Olson, Lucille Estate

Hanska
 New Ulm
 Bernalillo, NM
 Sleepy Eye
 New Ulm
 Lafayette
 Forest Lake
 Bellevue, NE
 Courtland
 New Ulm
 Ogema
 Sleepy Eye
 Sleepy Eye
 New Ulm
 Battle Lake
 Spicer
 Wabasso
 Sleepy Eye
 New Ulm
 Sleepy Eye
 New Ulm
 Hanska
 Winthrop
 Lafayette
 New Ulm
 Bigfork
 Watertown, WI
 New Ulm
 Silver Lake
 Chanhassen
 Tujunga, CA
 Chaska
 Webster
 New Ulm
 New Ulm
 Gaylord
 Sleepy Eye
 New Ulm
 Mankato
 Redwood Falls
 New Ulm
 Sleepy Eye
 Pasco, WA
 Chaska
 Logan, UT
 Hutchinson
 Mankato
 North Mankato
 Little Falls
 St. James
 Buffalo
 New Ulm
 Chanhassen
 New Ulm

Otsea, Glen A.
 Parsons, Lonnie D.
 Paschka, Joel & Tara
 Peters, Shawn
 Pilot, Joan M.
 Platz, Monica
 Prodoehl, D. A.
 Ramirez, Herbert
 Rasmussen, Christine J.
 Reed, Michael G.
 Reihls, Robert
 Reim, Dan
 Rice, Michael P.
 Rivera, Viviana
 Roberts, Jesse F.
 Robertson, Lola
 Rodriguez, Jose L.
 Roiger Lorraine A.
 Roiger, Steven A. Estate
 Sadler, DeWayne
 Sanchez, Orlando
 Sandmann, Eunice Estate
 Schiller, Harold H.
 Schilling, Paul S.
 Schueler, Dakota R.
 Scott, Kip A.
 Sellner, Elaine
 Sellner, Joseph C.
 Spicer, Debbie L.
 Tharp, Douglas E.
 TinaJero, Araceli Y.
 Torres, Nancy
 Trebelhorn, Robert
 Triax Midwest Ass., L.P.
 Trullinger, Justin
 Twenty 1st Century Wireless
 U.S. West Communications
 Warnke, Donald J.
 Weed, James R.
 Wieseler, James A.
 Wilke, Steven D.
 Winter Creek Farms
 Woodward, Laurie
 Worden, Jerry L.
 St. James
 International Falls
 Alexandria
 Arlington
 New Ulm
 Wilmette, IL
 Dardanelle, AR
 Madelia
 New Ulm
 Mankato
 Madelia
 North Mankato
 Grand Rapids
 Sleepy Eye
 New Ulm
 Sleepy Eye
 Sleepy Eye
 Sleepy Eye
 Sanborn
 Winthrop
 Sleepy Eye
 New Ulm
 Springfield
 Worthington
 Comfrey
 St. Paul
 Wells
 Mitchell, SD
 New Ulm
 Normal, IL
 New Ulm
 Sleepy Eye
 St. Peter
 Denver, CO
 New Ulm
 Edina
 Denver, CO
 Plainwell, MI
 New Ulm
 Mankato
 Lewisville
 Redwood Falls
 Eugene, OR
 Linwood, NE 



Take off winter chills & eat your fill with favorite chili recipes

Spice up a chilly night with a new chili recipe! Do you have a spicy hot recipe, what type of beans and meat do you use? Is it white chili or features canned garden tomatoes? Send your chili recipes to: Editor, Federated Rural Electric, PO Box 69, Jackson MN 56143-0069 or e-mail to christoffer@federatedrea.coop by February 25. Add your name and phone number. Thanks for sharing with us! ☺

Sweet Potato Bake by Phyllis Freemire, Heron Lake

4 or 6 sweet potatoes	3 T. cooking sherry or orange juice
½ c. brown sugar	¼ c. raisins
1 T. cornstarch	1 T. walnuts, chopped
¼ c. butter	

Cook potatoes. Peel and cut length wise. Arrange in a shallow pan or baking dish. Sprinkle with salt.

Mix in a sauce pan: brown sugar, cornstarch, juice; add raisins. Stir and bring to a boil. Pour over potatoes. Add nuts last. Bake at 350° for 25 minutes. ☺

Chicken Tator Bake by Roxanne Zimanski, Courtland

2 cans cream of chicken, undiluted	½ c. 2% milk
¼ c. butter, cubed	3 c. cooked chicken
1 pkg. frozen peas and carrots (I use half can of each — 15 oz. can size)	
1½ c. shredded cheddar cheese, divided	2 lb. pkg. frozen tator tots

In large saucepan combine the soup, milk and butter. Cook and stir over medium heat until heated through. Remove from heat; stir in chicken, peas, carrots and 1 c. of the cheese. Transfer this to a greased 9x13" pan.

Top with tator tots. Bake at 400° 25-30 minutes. Then sprinkle remaining cheese over the baked mixture and return to oven for about 5 minutes until this cheese melts. ☺

Chicken & Wild Rice Casserole by Sandy Kalfs, Okabena

6 oz. pkg. wild rice	
2 c. chicken, cooked & cubed	
1/3 c. onion, chopped	
¼ c. butter, melted	1/3 c. flour
1 tsp. salt	dash pepper
1 c. milk	1 c. chicken broth
1/3 c. parsley, chopped	
¼ c. almonds, chopped	

Cook rice according to package directions. In a two-quart casserole layer the rice and then the chicken. In a saucepan saute the onion in butter until tender. Gradually stir in the flour, salt, pepper, milk and broth, cooking until thick. Pour sauce over rice and chicken. Add parsley and almonds. Bake uncovered at 425° for 30 minutes. ☺

Godahl CTV transmitters upgraded

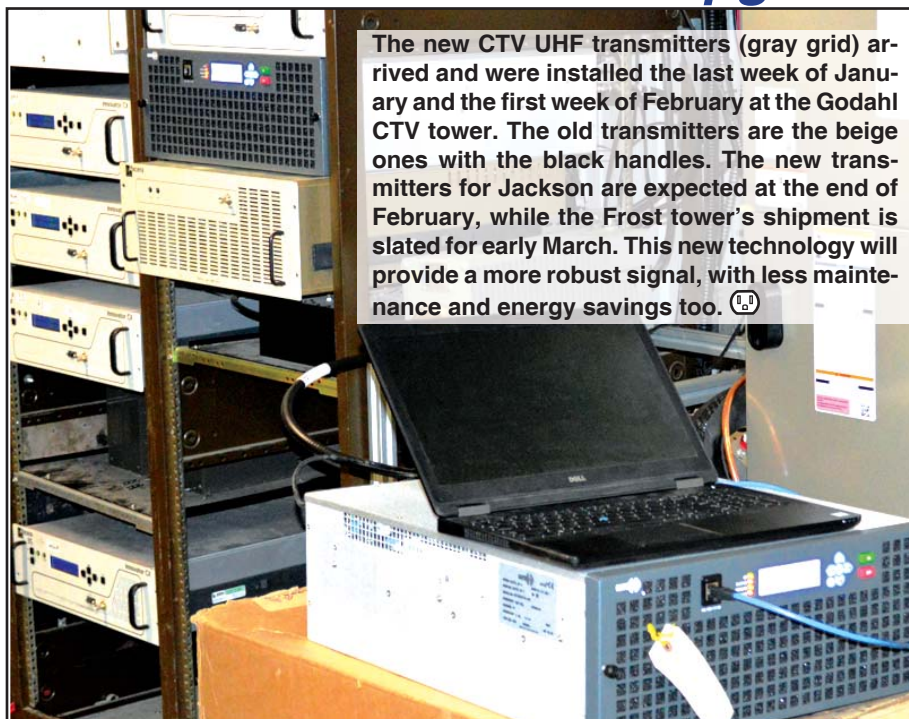

The new CTV UHF transmitters (gray grid) arrived and were installed the last week of January and the first week of February at the Godahl CTV tower. The old transmitters are the beige ones with the black handles. The new transmitters for Jackson are expected at the end of February, while the Frost tower's shipment is slated for early March. This new technology will provide a more robust signal, with less maintenance and energy savings too. ☺

**Pick up the phone
before the shovel;
call before digging!**

1-800-252-1166



Call Gopher State One Call before doing any digging more than 12" deep — 48 hours before digging for foundations, trees, tiling and more. You can also register at www.gopherstateonecall.org or call 811. Call a licensed electrician to locate the underground lines on your side of the meter. ☺



Scott Reimer

Manager's Message

2020's line construction by the numbers

I want to recap the 2020 construction:

- 23 services were rebuilt with two being overhead and 21 being underground.
- 53 new services were installed with 29 being overhead and 24 being underground.
- Three miles of three-phase overhead line were converted to underground and five miles of three-phase underground line were replaced due to age and system growth.

- Three miles of single-phase overhead line was converted to underground and three miles of single-phase underground line was rebuilt to three-phase underground; this provides backfeeds for substations to increase reliability and shorten outage times.

- 25 underground cable faults occurred with several of those sections replaced. As a comparison, 36 cable faults occurred in 2019 and 38 in 2018. We have prioritized replacement of the older underground cable on the system and that is built into our planning.

- Replaced three miles of single-phase underground cable, along with 33 service tap lines.

- In the substations all of the circuit reclosers in the Miloma sub were replaced with electronic reclosers. Replaced two three-phase reclosers with electronic reclosers in the Wisconsin sub.

- Completed the installation of three back-feed tie lines to the Heron Lake substation from our legacy substations.

- Installed a back-feed circuit to the Truman ITC sub.

- Rebuilt 15 miles of three-phase and 27 miles of single-phase overhead line from the 2019 ice storm rebuild projects.

2020 was a great year. Our crews, as well as our contractors, have a lot to show for their hard work. For comparison 639 poles were replaced in 2020. This number includes the lines that were rebuilt under work plans, ice storm-rebuild projects, underground-service rebuilds, pole changes and any other work orders that would have involved a pole replacement. Clearly we were committed to making the Federated system as reliable as possible and that trend will continue into 2021.

2021 construction work planned

See Page 5 for our 2021 construction work details, but here's an overview:

- We will be preparing to build a new substation in Sherburn.
- Replace at least 25 percent of our oil-filled line reclosers with electronic reclosers.
- Install Substation Control and Data Acquisition (SCADA) equipment in Miloma, Truman, West Lakefield and Wisconsin substations.
- Begin replacing aged single-phase overhead lines with underground. This will begin on the west side of the system in Jackson County, as a priority from our latest strategic plan.
- Continue to replace old, failing underground cable to eliminate outages.



Rural Electric

Official monthly newsletter published

77100 US Hwy 71, PO Box 69

Jackson, MN 56143-0069

E-mail: info@federatedrea.coop

Website: <http://www.federatedrea.coop>

Facebook.com/Federated

Phone: 847-3520 or 1-800-321-3520

Office hours: 8 a.m.-4:30 p.m. Monday-Friday

Scott Reimer, General Manager

David A. Hansen, President — 847-3530

David Meschke, Vice President — 236-4896

Darvin Voss, Secretary/Treasurer — 662-6679

Bruce Brockmann — 399-3487

Glenn Dicks — 840-1075

Jon Saxen — 236-7027

Scott Thiesse — 399-6427

The Board of Directors generally meets the last business day of the month at 8 a.m. at the Jackson office. Regular board meetings are open to the membership. Members interested in discussing business items should contact the general manager or president three days before the meeting.

- Replace the oldest transformers targeting those with the highest losses.

Safety is paramount with all of this construction work for our employees and membership. Tree trimming in both counties will continue. The crews' line patrol and infrared scanning of major components will be done to spot and repair small issues before they become outages.

Broadband internet remains a focus

The Federated Board of Directors has been taking a hard look at installing fiber to the home for our membership and those who want it. This is a major undertaking and will not happen without a great financial plan and financial assistance from grants. Both Jackson and Martin Counties need to play a role in this and those contacts will be made. While this is not our expertise, business partners will be needed and we are looking into that too.

The Rural Broadband Initiative is something that we have all heard about over the past several years; it is similar to how cooperatives began serving rural America with electric service when no one else would in the 1930s. We see broadband service as a similar role. The co-op business model is suited to bring gigabit-speed broadband coverage to rural America. We will keep you informed as things progress. 